JABI

e2open -

POs!

: _____

!

	4 (UTC) 1	
	5 / 1 5)	
	24 ()	- () Jabil PO
	00:00:00 UTC)	()
	12:30AM 12:30PM UTC	

HTML

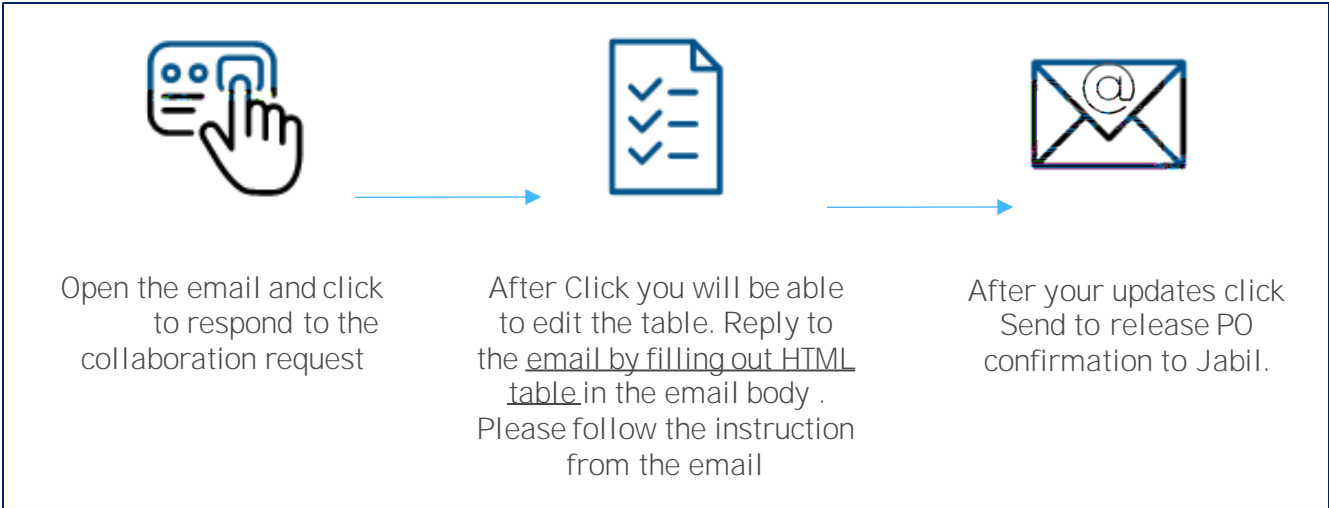

HTML



New Discrete Order Alert/新订单通知 [Ref:5c2a1e52-4d46-4677-87bc-c86e64cc039a] Inbox x

mailer@services.e2open.com

#ref25c757cd5-18dc297092										
Part	QTY	UOM	STATUS	EA	DATE	LOC	QTY	STATUS	TEST	DESCRIPTION
700	0	700	1	Unconfirmed	EA	2024-03-26	1302480460	1	Open	1
									0000260326	Test Connections ML1159313 Inc.
										Part Description 1 MPN1234 JABIL

WebClient

System of Discrete Business Order Alert

RO CONFIRMATION PROCESS

#ref25c757cd5-18dc297092										
Part	QTY	UOM	STATUS	EA	DATE	LOC	QTY	STATUS	TEST	DESCRIPTION
700	0	700	1	Unconfirmed	EA	2024-03-26	1302480460	1	Open	1
									0000260326	Test Connections ML1159313 Inc.
										Part Description 1 MPN1234 JABIL

/

HTML

" " " " (1).

!) / / (/ Jabil

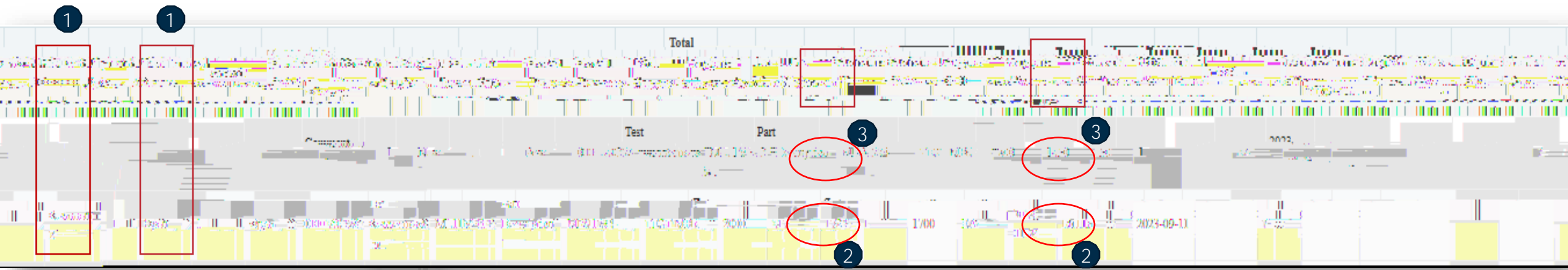

PO

() (Jabil)

= (!)

(Jabil)

! +

#Purchase	Line	Line	Schedule	Schedule	Supplier	Supplier	Jabil Part	Jabil Part	Manufacture	Manufacture	Request	Total	Open	Promise	Promise	Unit Of	Request	Rescheduling	Confirmed	Confirmed	Transit	Tracking	No Commit	Cancel	Cancel	Jabil	Supplier	Ship	Buyer	

1 " " " "

1

2

Part	2023-	Manufacture	Total	Confirmed	Comment	Test	Ship	Test

Jabil

_____ " " " "

Jabil

PO

1

1

5

4

6

2

3

6

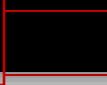
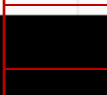
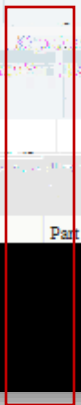

Next Steps

:

<https://www.jabil.com/about-us/supplier/supplier-collaboration.html>

JABIL

MADE P
MADE **BETTER.**